

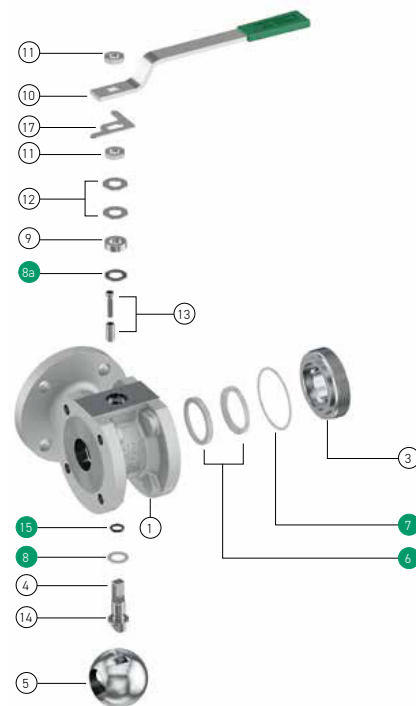

**A103 PN10-40
ANSI 150**
3 way wafer type ball
valve
INVESTMENT CASTING BODY
CORPO DA FUSIONE

PART NAME PARTICOLARE	QTY QTA'	MATERIALS MATERIALI	
1 body corpo	1	ASTM A216 WCB	ASTM A351 CF8M
3 closure chiusura	1	ASTM A216 WCB	ASTM A351 CF8M
4 stem stelo	1	ASTM A479 F6a (AISI 410)	ASTM A182 316/316L
5 ball sfera	1	ASTM A351 CF8M	
6 seats sedi	2	TFM	
7 body gasket guarnizione corpo	1	P.T.F.E.	
8 washer bussola	1	P.T.F.E.	
8a stem gasket guarnizione stelo	1	P.T.F.E.	
9 gland premi-guarnizione	1	Carbon Steel Zinc Coated	Stainless Steel 316
10 lever leva	1	Carbon Steel Zinc Coated	
11 stem nut dado stelo	2	Cl. 8	A4-40 (AISI 316)
12 spring washer molta a tazza	2	51CrV4 Zinc Coated	AISI 316
13 stop device dispositivo di arresto	1	Cl. 8.8 Zinc Coated	AISI 316
14 antistatic device dispositivo antistatico	2	AISI 316	
15 stem o-ring o-ring stelo	1	VITON 75 Sh. A	
16 body o-ring/o-ring corpo DN150 only	1	VITON 75 Sh. A	
17 position indicator indicatore di posizione	1	AISI 316	



Spares parts / Parti di ricambio

STANDARD FEATURES CARATTERISTICHE STANDARD

Flange Facing RF according to / Finitura Flange RF secondo : ASME B.16.5, ANSI 150 or EN 1092-1
Flange drilling, metric holes according / Foratura flange, fori metrici secondo : ASME B16.5 (ANSI 150) or EN 1092-1 (PN16)
Face to face / Scartamento : Manufacturer standard
Design according to / Progettazione secondo : ASME B16.34, EN 12516-1, PED 2014/68/UE
Antistatic Device according to / Dispositivo antistatico secondo : BS 5146
Tightness class / Classe di tenuta VI (FCI 70-2 - ANSI B 16.104)
Stem sealing with O-ring, Anti Blow-out stem / Tenuta stelo con O-Ring, stelo anti-espulsione
Actuator coupling flange according to / Flangia integrata per montaggio comando secondo : ISO 5211

A103 PN10-40 CARBON STEEL BODY / CORPO ACCIAIO AL CARBONIO

DN	VALVE RATING	VALVE CODE	DESCRIPTION	VALVE PRICE (€)	KIT CODE	KIT PRICE (€)
20	PN 10-40	AC320U4C1-0001-M0010	ALFA103 DN20 PN 10-40 WCB RF MET		KGAC320A1-001	
25	PN 10-40	AC325U4C1-0002-M0010	ALFA103 DN25 PN 10-40 WCB RF MET		KGAC325A1-001	
32	PN 10-40	AC332U4C1-0001-M0010	ALFA103 DN32 PN 10-40 WCB RF MET		KGAC332A1-001	
40	PN 10-40	AC340U4C1-0002-M0010	ALFA103 DN40 PN 10-40 WCB RF MET		KGAC340A1-001	
50	PN 10-40	AC350U4C1-0001-M0010	ALFA103 DN50 PN 10-40 WCB RF MET		KGAC350A1-001	
65	PN 10-16	AC365U3C1-0001-M0010	ALFA103 DN65 PN 10-16 WCB RF MET		KGAC365A1-001	
80	PN 16-40	AC380U4C1-0002-M0010	ALFA103 DN80 PN 16-40 WCB RF MET		KGAC380A1-001	
100	PN 10-16	AC3A0U3C1-0001-M0010	ALFA103 DN100 PN 10-16 WCB RF MET		KGAC3A0A1-001	
150	PN 10-16	AC3A5U3C1-0001-M0010	ALFA103 DN150 PN 10-16 WCB RF MET		KGAC3A5A1-001	

A103 PN10-40 STAINLESS STEEL BODY / CORPO ACCIAIO INOSSIDABILE

DN	VALVE RATING	VALVE CODE	DESCRIPTION	VALVE PRICE (€)	KIT CODE	KIT PRICE (€)
20	PN 10-40	AC320U4S2-0001-M0000	ALFA103 DN20 PN 10-40 CF8M RF		KGAC320A1-001	
25	PN 10-40	AC325U4S2-0001-M0000	ALFA103 DN25 PN 10-40 CF8M RF		KGAC325A1-001	
32	PN 10-40	AC332U4S2-0001-M0000	ALFA103 DN32 PN 10-40 CF8M RF		KGAC332A1-001	
40	PN 10-40	AC340U4S2-0001-M0000	ALFA103 DN40 PN 10-40 CF8M RF		KGAC340A1-001	
50	PN 10-40	AC350U4S2-0001-M0000	ALFA103 DN50 PN 10-40 CF8M RF		KGAC350A1-001	
65	PN 10-16	AC365U3S2-0001-M0000	ALFA103 DN65 PN 10-16 CF8M RF		KGAC365A1-001	
80	PN 16-40	AC380U6S2-0001-M0000	ALFA103 DN80 PN 16-40 CF8M RF		KGAC380A1-001	
100	PN 10-16	AC365U3S2-0001-M0000	ALFA103 DN100 PN 10-16 CF8M RF		KGAC3A0A1-001	
150	PN 10-16	AC3A5U3S2-0001-M0000	ALFA103 DN150 PN 10-16 CF8M RF		KGAC3A5A1-001	



Product codes in bold are related to product available on stock: delivery time within 3 weeks based on ordered quantity.

All other codes are related to product ready for assembly: delivery time within 5 weeks based on ordered quantity.

Missing Sizes and Special Executions are available upon request. Please contact Sales Dept. for availability and delivery time.

I codici in grassetto indicano prodotti normalmente disponibili a stock: consegna entro 3 settimane secondo quantità ordinate.

Gli altri codici indicano prodotti disponibili per assemblaggio: consegna entro 5 settimane secondo quantità ordinate.

Dimensioni mancanti ed esecuzioni speciali sono disponibili su richiesta. Si prega contattare Ufficio commerciale per disponibilità e consegne.

A103 ANSI 150
CARBON STEEL BODY / CORPO ACCIAIO AL CARBONIO

WCB

DN	VALVE RATING	CODE	DESCRIPTION	VALVE PRICE (€)	KIT CODE	KIT PRICE (€)
20	ANSI 150	AC320A1C1-0001-M0010	ALFA103 DN20 ANSI150 WCB RF MET		KGAC320A1-001	
25	ANSI 150	AC325A1C1-0002-M0010	ALFA103 DN25 ANSI150 WCB RF MET		KGAC325A1-001	
32	ANSI 150	AC332A1C1-0001-M0010	ALFA103 DN32 ANSI150 WCB RF MET		KGAC332A1-001	
40	ANSI 150	AC340A1C1-0002-M0010	ALFA103 DN40 ANSI150 WCB RF MET		KGAC340A1-001	
50	ANSI 150	AC350A1C1-0001-M0010	ALFA103 DN50 ANSI150 WCB RF MET		KGAC350A1-001	
65	ANSI 150	AC365A1C1-0002-M0010	ALFA103 DN65 ANSI150 WCB RF MET		KGAC365A1-001	
80	ANSI 150	AC380A1C1-0002-M0010	ALFA103 DN80 ANSI150 WCB RF MET		KGAC380A1-001	
100	ANSI 150	AC3A0A1C1-0001-M0010	ALFA103 DN100 ANSI150 WCB RF MET		KGAC3A0A1-001	
150	ANSI 150	AC3A5A1C1-0001-M0010	ALFA103 DN150 ANSI150 WCB RF MET		KGAC3A5A1-001	

A103 ANSI 150
STAINLESS STEEL BODY / CORPO ACCIAIO INOSSIDABILE

CF8M

DN	VALVE RATING	CODE	DESCRIPTION	VALVE PRICE (€)	KIT CODE	KIT PRICE (€)
20	ANSI 150	AC320A1S2-0001-M0000	ALFA103 DN20 ANSI150 CF8M RF MET		KGAC320A1-001	
25	ANSI 150	AC325A1S2-0001-M0000	ALFA103 DN25 ANSI150 CF8M RF MET		KGAC325A1-001	
32	ANSI 150	AC332A1S2-0001-M0000	ALFA103 DN32 ANSI150 CF8M RF MET		KGAC332A1-001	
40	ANSI 150	AC340A1S2-0001-M0000	ALFA103 DN40 ANSI150 CF8M RF MET		KGAC340A1-001	
50	ANSI 150	AC350A1S2-0001-M0000	ALFA103 DN50 ANSI150 CF8M RF MET		KGAC350A1-001	
65	ANSI 150	AC365A1S2-0001-M0000	ALFA103 DN65 ANSI150 CF8M RF MET		KGAC365A1-001	
80	ANSI 150	AC380A1S2-0001-M0000	ALFA103 DN80 ANSI150 CF8M RF MET		KGAC380A1-001	
100	ANSI 150	AC3A0A1S2-0001-M0000	ALFA103 DN100 ANSI150 CF8M RF MET		KGAC3A0A1-001	
150	ANSI 150	AC3A5A1S2-0001-M0000	ALFA103 DN150 ANSI150 CF8M RF MET		KGAC3A5A1-001	



Product codes in bold are related to product available on stock: delivery time within 3 weeks based on ordered quantity.

All other codes are related to product ready for assembly: delivery time within 5 weeks based on ordered quantity.
Missing Sizes and Special Executions are available upon request. Please contact Sales Dept. for availability and delivery time

I codici in grassetto indicano prodotti normalmente disponibili a stock: consegna entro 3 settimane secondo quantità ordinate

Gli altri codici indicano prodotti disponibili per assemblaggio: consegna entro 5 settimane secondo quantità ordinate

Dimensioni mancanti ed esecuzioni speciali sono disponibili su richiesta. Si prega contattare Ufficio commerciale per disponibilità e consegne